

Solstice Park

news

Issue 5
Summer 2006



Green light for office scheme

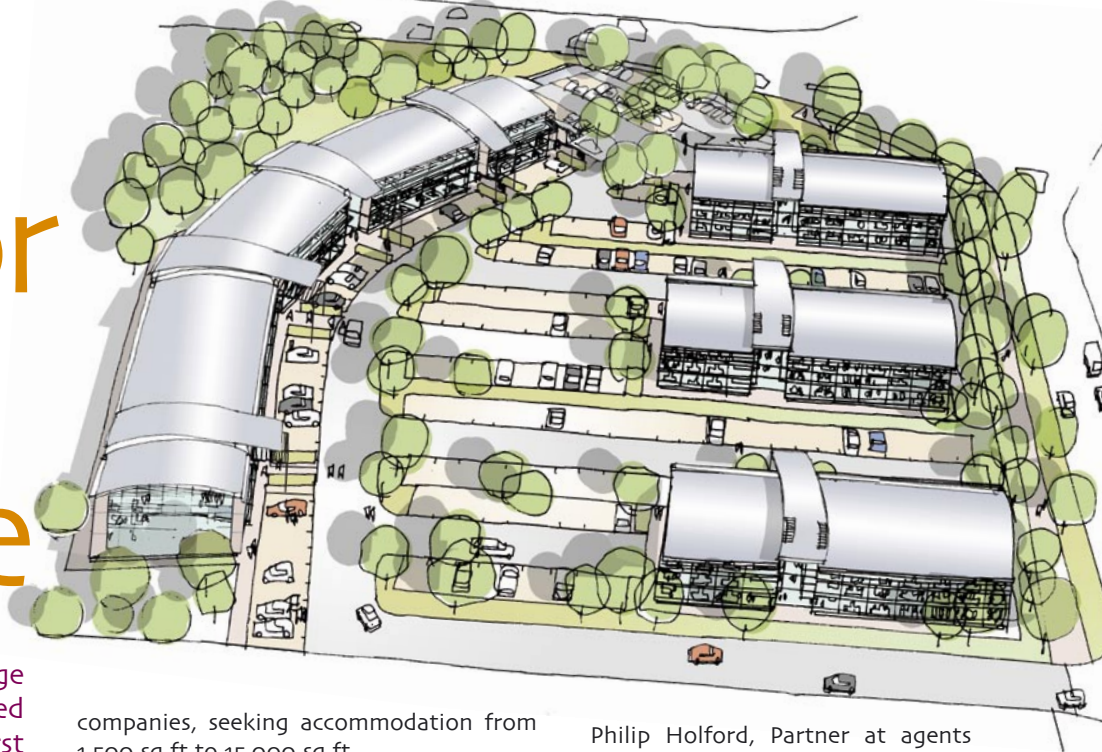

An office scheme providing a range of suites has been granted detailed consent and will become the first speculative office development at Solstice Park.

To be known as 'The Crescent', the complex will provide 66,000 sq ft of new, energy efficient offices for small to medium size

companies, seeking accommodation from 1,500 sq ft to 15,000 sq ft.

New access and infrastructure for the 20 acre office campus was completed in June 2006, allowing construction to commence on the offices, due to be ready for occupation in early 2007.

Philip Holford, Partner at agents Myddelton & Major commented "There has been strong interest in these new high quality offices. In a business park environment, flexibility with generous on-site parking is just what the market needs".



LANDMARK BUILDING

Construction is well-underway on the 140 bedroom hotel at Solstice Services. The hotel will form a striking icon from the A303, creating a landmark entrance to this attractive business park.

The Holiday Inn franchise was recently appointed as the hotel operator; who announced that the hotel has aptly been named 'Holiday Inn Stonehenge'.

The high quality hotel will include a welcoming wine bar/

restaurant, and the menu will feature Mediterranean-inspired dishes, with an emphasis on fish; thus differing from the other roadside establishments. Conference facilities will also be available.

From early 2007, Holiday Inn Stonehenge will cater for business clients and visitors to historic South Wiltshire.

Peter Barefoot, Partner at Alder King commented "This will be a truly magnificent landmark building at the entrance to the £250 million Business Park development".



Further information from:



www.solsticepark.com



BUSINESS AWARDS

Solstice Park is a proud sponsor of The South Wiltshire Business of the Year Awards 2006.

Now in its 7th year, the Awards offer five categories with a superb prize package for every winner and runner-up, plus valuable exposure for their company. The winners will be announced during an awards ceremony at the Salisbury Arts Centre, in early July. Watch this space!

ROADSIDE AND LEISURE ZONE

Solstice Park is delighted to announce that all sites have now been reserved on the 11 acre Roadside and Leisure zone.

The final sites will house an impressive private sports and leisure club, which will provide multi-purpose outdoor courts, a gym, an indoor 20 metre fitness pool,

sauna, steam room and squash courts. A planning application for the scheme is due to be submitted to Salisbury District Council in June 2006.

The Roadside and Leisure zone is vibrant with national brands, including a 24 hour Petrol Filling Station with Somerfield Essentials convenience store, The Amesbury Archer (Brewers Fayre) family

pub restaurant, a Pizza Hut restaurant and a Kentucky Fried Chicken (KFC) restaurant with a drive thru.

A local businessman, Andy Williams, from the Amesbury Printing Company Limited, said "Solstice Services is a marvellous complex and a breath of fresh air. I was amazed to discover the range of products at Somerfield".

UPDATE ON THE BEACON CENTRE

Construction work has now been completed on the fifteen trade counter/warehouse units known as The Beacon Centre.

Joint agents, Myddelton & Major and Alder King, report strong interest in the quality scheme, with five more units being placed under offer and definitive interest shown in several others.

The Beacon Centre provides high quality, new units, within an attractive business park, adjacent to the A303 trunk road. There is unrivalled accessibility to the A303, providing excellent communication links for employees, clients and markets.

The remaining units are available freehold, or to let and range in size from 1,900 sq ft to 3,900 sq ft.



A DATE FOR YOUR DIARY

Wednesday 27th September, South Wilts Expo, City Hall, Salisbury (09.00 – 18.00 hrs). Come and see us at the Solstice Park stand.